

Garden Terrace/Log Cabin

Ground Floor

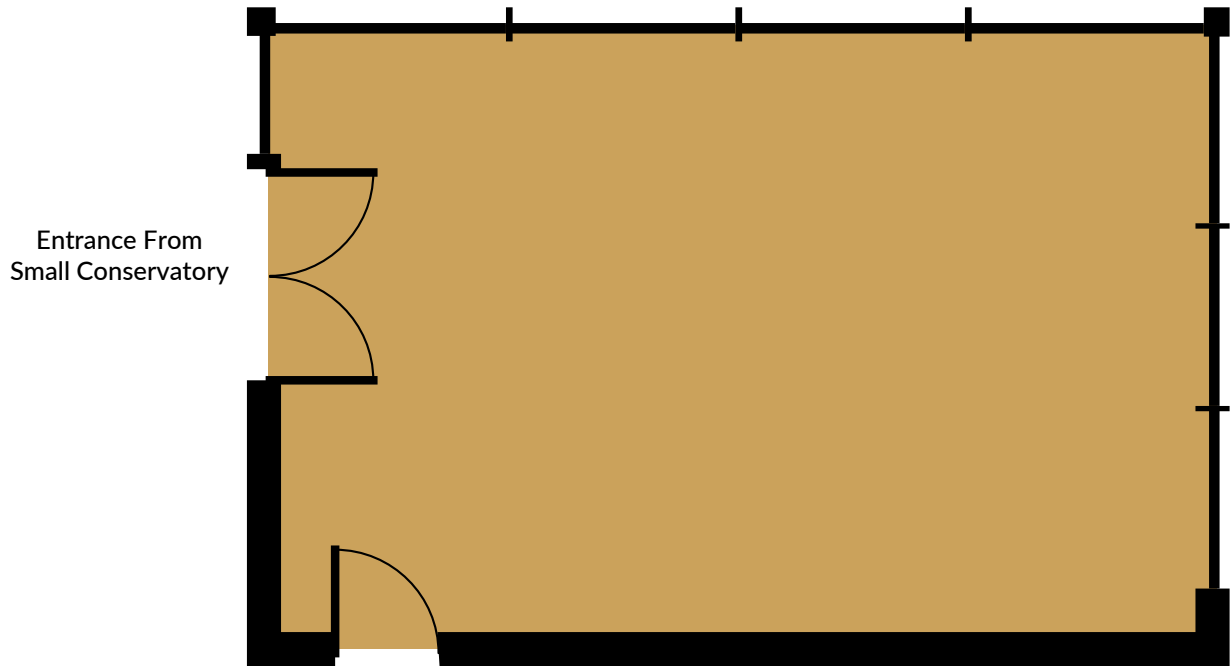

Entrance From
Small Conservatory

Entrance From Lobby

CAPACITIES		
THEATRE		20
U-SHAPE		20
CLASSROOM		N/A
BOARDROOM		16
CABARET		6
DINNER		8 (ROUND TABLE)
RECEPTION		30

DIMENSIONS	
LENGTH	6.5
WIDTH	4.6
HEIGHT	2.5
AREA	29.9

FACILITIES	
DAYLIGHT	YES
PILLARS	NO
HEATERS	YES
AIR-CON	YES
EQUIPMENT	NO



*THE GARDEN TERRACE HAS A PERMANENT CANOPY